



POLSKI KOMITET
NORMALIZACYJNY

P O L S K A N O R M A

ICS 25.160.40

PN-EN ISO 10675-2

Wprowadza

EN ISO 22825:2017, IDT

ISO 22825:2017, IDT

Zastępuje

PN-EN ISO 10675-2:2013-12

Badanie nieniszczące spoin

Kryteria akceptacji badań radiograficznych

Część 2: Aluminium i jego stopy

Norma Europejska EN ISO 10675-2:2017 *Non-destructive testing of welds – Acceptance levels for radiographic testing – Part 2: Aluminium and its alloys (ISO 10675-2:2017)* ma status Polskiej Normy

© Copyright by PKN, Warszawa 2017

nr ref. PN-EN ISO 10675-2:2017-12

Wszelkie prawa autorskie zastrzeżone. Żadna część niniejszej publikacji nie może być zwielokrotniana jakkolwiek techniką bez pisemnej zgody Prezesa Polskiego Komitetu Normalizacyjnego

ISBN 978-83-275-8908-8

PN-EN ISO 10675-2:2017-12

Przedmowa krajowa

Niniejsza norma została zatwierdzona przez Prezesa PKN dnia 22 grudnia 2017 r.

Komitetem krajowym odpowiedzialnym za normę jest KT nr 165 ds. Spawania i Procesów Pokrewnych.

Istnieje możliwość przetłumaczenia normy na język polski na wniosek zainteresowanych środowisk. Decyzję podejmuje właściwy Komitet Techniczny.

Niniejsza norma zastępuje PN-EN ISO 10675-2:2013-12.

Odpowiedniki krajowe norm i innych dokumentów powołanych w niniejszej normie można znaleźć w katalogu Polskich Norm. Oryginały norm i innych dokumentów powołanych są dostępne w PKN.

W sprawach merytorycznych dotyczących treści normy można zwracać się do właściwego Komitetu Technicznego lub właściwej Rady Sektorowej PKN, kontakt: www.pkn.pl

Nota uznaniowa

Norma Europejska EN ISO 10675-2:2017 została uznana przez PKN za Polską Normę PN-EN ISO 10675-2:2017-12.

EUROPEAN STANDARD

EN ISO 10675-2

NORME EUROPÉENNE

EUROPÄISCHE NORM

November 2017

ICS 25.160.40

Supersedes EN ISO 10675-2:2013

English Version

**Non-destructive testing of welds - Acceptance levels for
radiographic testing - Part 2: Aluminium and its alloys (ISO
10675-2:2017)**

Essais non destructifs des assemblages soudés -
Niveaux d'acceptation pour l'évaluation par
radiographie - Partie 2: Aluminium et ses alliages (ISO
10675-2:2017)

Zerstörungsfreie Prüfung von Schweißverbindungen -
Zulässigkeitsgrenzen für die Durchstrahlungsprüfung -
Teil 2: Aluminium und seine Legierungen (ISO 10675-
2:2017)

This European Standard was approved by CEN on 31 October 2017.

CEN members are bound to comply with the CEN/CENELEC Internal Regulations which stipulate the conditions for giving this European Standard the status of a national standard without any alteration. Up-to-date lists and bibliographical references concerning such national standards may be obtained on application to the CEN-CENELEC Management Centre or to any CEN member.

This European Standard exists in three official versions (English, French, German). A version in any other language made by translation under the responsibility of a CEN member into its own language and notified to the CEN-CENELEC Management Centre has the same status as the official versions.

CEN members are the national standards bodies of Austria, Belgium, Bulgaria, Croatia, Cyprus, Czech Republic, Denmark, Estonia, Finland, Former Yugoslav Republic of Macedonia, France, Germany, Greece, Hungary, Iceland, Ireland, Italy, Latvia, Lithuania, Luxembourg, Malta, Netherlands, Norway, Poland, Portugal, Romania, Serbia, Slovakia, Slovenia, Spain, Sweden, Switzerland, Turkey and United Kingdom.



EUROPEAN COMMITTEE FOR STANDARDIZATION
COMITÉ EUROPÉEN DE NORMALISATION
EUROPÄISCHES KOMITEE FÜR NORMUNG

CEN-CENELEC Management Centre: Avenue Marnix 17, B-1000 Brussels

EN ISO 10675-2:2017 (E)

Contents	Page
European foreword.....	3

European foreword

This document (EN ISO 10675-2:2017) has been prepared by Technical Committee ISO/TC 44 “Welding and allied processes” in collaboration with Technical Committee CEN/TC 121 “Welding and allied processes” the secretariat of which is held by DIN.

This European Standard shall be given the status of a national standard, either by publication of an identical text or by endorsement, at the latest by May 2018, and conflicting national standards shall be withdrawn at the latest by May 2018.

Attention is drawn to the possibility that some of the elements of this document may be the subject of patent rights. CEN shall not be held responsible for identifying any or all such patent rights.

This document supersedes EN ISO 10675-2:2013.

According to the CEN-CENELEC Internal Regulations, the national standards organizations of the following countries are bound to implement this European Standard: Austria, Belgium, Bulgaria, Croatia, Cyprus, Czech Republic, Denmark, Estonia, Finland, Former Yugoslav Republic of Macedonia, France, Germany, Greece, Hungary, Iceland, Ireland, Italy, Latvia, Lithuania, Luxembourg, Malta, Netherlands, Norway, Poland, Portugal, Romania, Serbia, Slovakia, Slovenia, Spain, Sweden, Switzerland, Turkey and the United Kingdom.

Endorsement notice

The text of ISO 10675-2:2017 has been approved by CEN as EN ISO 10675-2:2017 without any modification.

INTERNATIONAL STANDARD

ISO 10675-2

Second edition
2017-09

Non-destructive testing of welds — Acceptance levels for radiographic testing —

Part 2: Aluminium and its alloys

*Essais non destructifs des assemblages soudés — Niveaux
d'acceptation pour l'évaluation par radiographie —*

Partie 2: Aluminium et ses alliages



Reference number
ISO 10675-2:2017(E)

© ISO 2017

ISO 10675-2:2017(E)



COPYRIGHT PROTECTED DOCUMENT

© ISO 2017, Published in Switzerland

All rights reserved. Unless otherwise specified, no part of this publication may be reproduced or utilized otherwise in any form or by any means, electronic or mechanical, including photocopying, or posting on the internet or an intranet, without prior written permission. Permission can be requested from either ISO at the address below or ISO's member body in the country of the requester.

ISO copyright office
Ch. de Blandonnet 8 • CP 401
CH-1214 Vernier, Geneva, Switzerland
Tel. +41 22 749 01 11
Fax +41 22 749 09 47
copyright@iso.org
www.iso.org

Contents

Page

Foreword	iv
1 Scope	1
2 Normative references	1
3 Terms and definitions	1
4 Radiographic technique	1
5 General	2
6 Acceptance levels	2
Annex A (informative) Guide to the limitations of radiographic testing	5
Annex B (informative) Examples for determination of percentage (%) of imperfections	6
Annex C (informative) Sums of acceptable areas	8
Bibliography	10

ISO 10675-2:2017(E)

Foreword

ISO (the International Organization for Standardization) is a worldwide federation of national standards bodies (ISO member bodies). The work of preparing International Standards is normally carried out through ISO technical committees. Each member body interested in a subject for which a technical committee has been established has the right to be represented on that committee. International organizations, governmental and non-governmental, in liaison with ISO, also take part in the work. ISO collaborates closely with the International Electrotechnical Commission (IEC) on all matters of electrotechnical standardization.

The procedures used to develop this document and those intended for its further maintenance are described in the ISO/IEC Directives, Part 1. In particular the different approval criteria needed for the different types of ISO documents should be noted. This document was drafted in accordance with the editorial rules of the ISO/IEC Directives, Part 2 (see www.iso.org/directives).

Attention is drawn to the possibility that some of the elements of this document may be the subject of patent rights. ISO shall not be held responsible for identifying any or all such patent rights. Details of any patent rights identified during the development of the document will be in the Introduction and/or on the ISO list of patent declarations received (see www.iso.org/patents).

Any trade name used in this document is information given for the convenience of users and does not constitute an endorsement.

For an explanation on the voluntary nature of standards, the meaning of ISO specific terms and expressions related to conformity assessment, as well as information about ISO's adherence to the World Trade Organization (WTO) principles in the Technical Barriers to Trade (TBT) see the following URL: www.iso.org/iso/foreword.html.

This document was prepared by Technical Committee ISO/TC 44, *Welding and allied processes*, Subcommittee SC 5, *Testing and inspection of welds*.

This second edition cancels and replaces the first edition (ISO 10675-2:2010), of which it constitutes a minor revision and contains the following main changes:

- the normative references have been updated;
- Table 1 has been split into two separate tables.

Request for official interpretations of any aspect of this document should be directed to the Secretariat of ISO/TC 44/SC 5 via your national standards body. A complete listing of these bodies can be found at www.iso.org.

Non-destructive testing of welds — Acceptance levels for radiographic testing —

Part 2: Aluminium and its alloys

1 Scope

This document specifies acceptance levels for indications from imperfections in aluminium butt welds detected by radiographic testing. If agreed, the acceptance levels can be applied to other types of welds or materials.

The acceptance levels can be related to welding standards, application standards, specifications or codes. This document assumes that the radiographic testing has been carried out in accordance with ISO 17636-1 for RT-F (F = film) or ISO 17636-2 for RT-S (S = radioscopy) and RT-D (D = digital detectors).

When assessing whether a weld meets the requirements specified for a weld quality level, the sizes of imperfections permitted by standards are compared with the dimensions of indications revealed by a radiograph made of the weld.

2 Normative references

The following documents are referred to in the text in such a way that some or all of their content constitutes requirements of this document. For dated references, only the edition cited applies. For undated references, the latest edition of the referenced document (including any amendments) applies.

ISO 6520-1, *Welding and allied processes — Classification of geometric imperfections in metallic materials — Part 1: Fusion welding*

ISO 10042, *Welding — Arc-welded joints in aluminium and its alloys — Quality levels for imperfections*

ISO 17636-1, *Non-destructive testing of welds — Radiographic testing — Part 1: X- and gamma-ray techniques with film*

ISO 17636-2, *Non-destructive testing of welds — Radiographic testing — Part 2: X- and gamma-ray techniques with digital detectors*

3 Terms and definitions

No terms and definitions are listed in this document.

ISO and IEC maintain terminological databases for use in standardization at the following addresses:

- ISO Online browsing platform: available at <http://www.iso.org/obp>
- IEC Electropedia: available at <http://www.electropedia.org/>

4 Radiographic technique

Depending on the weld quality level, radiographic technique A or B in accordance with ISO 17636-1 shall be used for RT-F as shown in [Table 1](#) and radiographic technique A or B in accordance with ISO 17636-2 shall be used for RT-S or RT-D as shown in [Table 2](#).

ISO 10675-2:2017(E)

Table 1 — Radiographic testing for RT-F

Quality levels in accordance with ISO 10042	Testing techniques and classes in accordance with ISO 17636-1 for RT-F ^a	Acceptance levels in accordance with this document
B	B	1
C	B ^{a,b}	2
D	A	3

^a RT-F = Radiographic testing with film

^b However, the minimum number of exposure for circumferential weld testing may correspond to the requirements of class A of ISO 17636-1.

Table 2 — Radiographic testing for RT-S and RT-D

Quality levels in accordance with ISO 10042	Testing techniques and classes in accordance with ISO 17636-2 for RT-S ^a and RT-D ^b	Acceptance levels in accordance with this document
B	B	1
C	B ^c	2
D	A	3

^a RT-S = Radioscopic testing

^b RT-D = Radiographic testing with digital detectors

^c However, the minimum number of exposure for circumferential weld testing may correspond to the requirements of class A of ISO 17636-2.

5 General

Welded joints should be visually tested in accordance with ISO 17637 and evaluated before radiographic testing.

The acceptance levels in this document are basically valid for evaluation of imperfections which cannot be detected and evaluated by visual testing (see [Table 3](#)). Surface imperfections (see [Table 4](#); such as undercut and excessive penetration, surface damage, weld spatter, etc.) which due to object geometry cannot be evaluated, but where the interpreter suspects the ISO 10042 quality levels are not fulfilled, shall be subject to more specific testing.

When quantification of undercut and/or excessive penetration by radiographic testing is required, specific procedures using test exposures may be applied in order to establish a basis for approximate quantification in accordance with the requirements of ISO 10042. This shall be specified.

6 Acceptance levels

The acceptance levels for indications are shown in [Table 3](#) and [Table 4](#). The types of imperfections are selected from ISO 10042 and defined in ISO 6520-1.

The symbols used in [Table 3](#) and [Table 4](#) are the following:

- A* is the sum of projected areas of indications related to $L \times w_p$ in %;
- b* is the width of excess penetration of weld, in millimetres;
- d* is the diameter of pore, in millimetres;
- d_A* is the diameter of area surrounding a cluster, in millimetres;

- h is the width of indication, the width or height of surface or cross surface imperfection, in millimetres;
- l is the length of indication, in millimetres;
- L any 100 mm testing length, in millimetres;
- s is the nominal butt weld thickness, in millimetres;
- t is the material thickness, in millimetres;
- w_p is the width of the weld, in millimetres;
- $\sum l$ is the summary length of imperfections within L .

Any two adjacent imperfections separated by a distance smaller than the major dimension of the smaller imperfection shall be considered as a single imperfection.

Indications shall not be divided into different ranges L .

Table 3 — Acceptance levels for indications in butt welds

No.	Type of internal imperfections in accordance with ISO 6520-1	Acceptance level 3 ^a	Acceptance level 2 ^a	Acceptance level 1
1	Cracks (100)	Not permitted	Not permitted	Not permitted
2a	Gas pores (2011)	$d \leq 0,4s$, max. 6 mm	$d \leq 0,3s$, max. 5 mm	$d \leq 0,2s$, max. 4 mm
2b	Porosity (2012) material thickness 0,5 mm to 3 mm	$A \leq 6\%$ $L = 100$ mm	$A \leq 2\%$ $L = 100$ mm	$A \leq 1\%$ $L = 100$ mm
2c	Porosity (2012) material thickness >3 mm to 12 mm	$A \leq 10\%$ $L = 100$ mm	$A \leq 4\%$ $L = 100$ mm	$A \leq 2\%$ $L = 100$ mm
2d	Porosity (2012) material thickness >12 mm to 30 mm	$A \leq 15\%$ $L = 100$ mm	$A \leq 6\%$ $L = 100$ mm	$A \leq 3\%$ $L = 100$ mm
2e	Porosity (2012) material thickness >30 mm	$A \leq 20\%$ $L = 100$ mm	$A \leq 8\%$ $L = 100$ mm	$A \leq 4\%$ $L = 100$ mm
3b	Clustered (localized) porosity (2013)	$d_A \leq 25$ mm or $d_{A,max} \leq w_p$	$d_A \leq 20$ mm or $d_{A,max} \leq w_p$	$d_A \leq 15$ mm or $d_{A,max} \leq w_p/2$
4c	Linear porosity (2014)	$l \leq 25$ mm $L = 100$ mm	Not permitted	Not permitted
5 ^d	Elongated cavities (2015) and wormholes (2016)	$l \leq 0,4s$, max. 6 mm	$l < 0,3s$, max. 4 mm	$l < 0,2s$, max. 3 mm
6	Oxide inclusion (303)	$l < s$, max. 10 mm	$l < 0,5s$, max. 5 mm	$l < 0,2s$, max. 3 mm
a	Acceptance levels 3 and 2 may be specified with suffix X which denotes that all indications over 25 mm are unacceptable.			
b	See Figure C.1 and Figure C.2 (normative).			
c	See Figure C.3 and Figure C.4 (normative).			
d	See Figure C.5 and Figure C.6 (normative).			
e	If the length of the weld is below 100 mm, the maximum length of indications shall not exceed 25 % of that weld.			

ISO 10675-2:2017(E)

Table 3 (continued)

No.	Type of internal imperfections in accordance with ISO 6520-1	Acceptance level 3 ^a	Acceptance level 2 ^a	Acceptance level 1
7	Tungsten inclusions (3041)	$l < 0,4s$, max. 6 mm	$l < 0,3s$, max. 4 mm	$l < 0,2s$, max. 3 mm
8 ^e	Lack of fusion (401)	Permitted, but only intermittently and not breaking the surface $l \leq 25$ mm, $L = 100$ mm	Not permitted	Not permitted
9 ^e	Lack of penetration (402)	$l < 25$ mm, $L = 100$ mm	Permitted provided welded from both sides and not breaking the surface $l \leq 25$ mm, $L = 100$ mm	Not permitted

^a Acceptance levels 3 and 2 may be specified with suffix X which denotes that all indications over 25 mm are unacceptable.

^b See [Figure C.1](#) and [Figure C.2](#) (normative).

^c See [Figure C.3](#) and [Figure C.4](#) (normative).

^d See [Figure C.5](#) and [Figure C.6](#) (normative).

^e If the length of the weld is below 100 mm, the maximum length of indications shall not exceed 25 % of that weld.

Table 4 — Surface imperfections

No.	Type of surface imperfections in accordance with ISO 6520-1	Acceptance level 3 ^a	Acceptance level 2 ^a	Acceptance level 1
10	Crater cracks (104)	$l \leq 0,4s$	Not permitted	Not permitted
11a	Continuous undercut (5011)	Smooth transition is required $h \leq 0,2t$, max. 1 mm	Smooth transition is required $h \leq 0,1t$, max. 0,5 mm	Not permitted
11b	Intermittent undercut (5012)	Smooth transition is required $h \leq 0,2t$, max. 1,5 mm $l \leq 25$ mm	Smooth transition is required $h \leq 0,1t$, max. 1 mm $l \leq 25$ mm	Smooth transition is required $h \leq 0,1t$, max. 0,5 mm $l \leq 25$ mm
12	Excess penetration (504)	$h \leq 5$ mm	$h \leq 4$ mm	$h \leq 3$ mm
13	Root concavity (515)	$l \leq 25$ mm $h \leq 0,2t$, max. 1,5 mm	$l \leq 25$ mm $h \leq 0,1t$, max. 1 mm	$l \leq 25$ mm $h \leq 0,05t$, max. 0,5 mm
14	Shrinkage groove (5013)	$l \leq 25$ mm $h \leq 0,2t$, max. 1,5 mm	$l \leq 25$ mm $h \leq 0,1t$, max. 1 mm	$l \leq 25$ mm $h \leq 0,05t$, max. 0,5 mm

NOTE The acceptance levels are those defined for visual testing. These imperfections are normally evaluated by visual testing.

^a Acceptance levels 3 and 2 may be specified with suffix X which denotes that all indications over 25 mm are unacceptable.

Annex A (informative)

Guide to the limitations of radiographic testing

A.1 General

NOTE The numbers between brackets conform to those used in ISO 6520-1.

A.2 Volumetric imperfections in butt welds

- Porosities and gas pores (2011, 2013, 2015 and 2017)
- Wormholes and elongated cavities (2016 and 2015)
- Oxide inclusions (303)
- Tungsten inclusions (3041)

The above imperfections listed in [Table 3](#) will be readily detected using radiographic technique A or B of ISO 17636-1 for RT-F as shown in [Table 1](#), or ISO 17636-2 for RT-S or RT-D as shown in [Table 2](#).

A.3 Cracks in butt welds

- Crater cracks (104)
- Cracks (100)

The detectability of cracks by radiographic testing depends on the crack height, the ramification (presence of branching parts), opening width, direction of the X-ray beam to crack orientation and radiographic technique parameters.

Reliable detection of all cracks is therefore limited. The use of radiographic technique B or better, as specified in ISO 17636-1 and ISO 17636-2, will provide better crack detectability than radiographic technique A.

A.4 Planar imperfections in butt welds

- Lack of fusion (401)
- Lack of penetration (402)

The detection of lack of fusion and lack of penetration depends on characteristics of imperfections and radiographic technique parameters.

Lack of side wall fusion will probably not be detected (except it is associated with other imperfections such as slag inclusions) unless it is radiographed in direction of the side wall.

Annex B (informative)

Examples for determination of percentage (%) of imperfections

[Figure B.1](#) to [Figure B.9](#) give a presentation of different area percentage (%) of imperfections. This should assist the assessment of imperfections on radiographs and fracture surfaces.

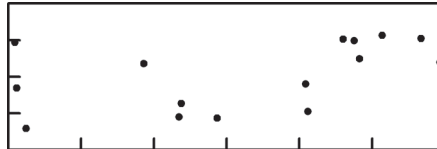

Figure B.1 — 1 %

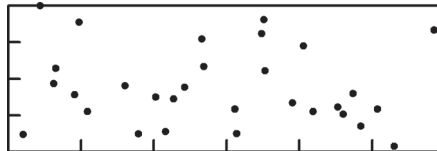

Figure B.2 — 2 %

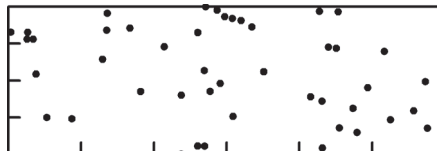

Figure B.3 — 3 %

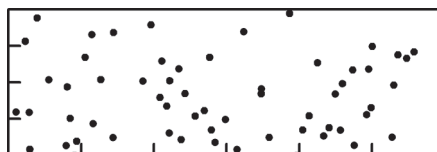

Figure B.4 — 4 %

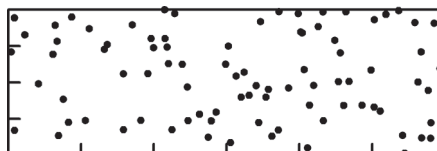

Figure B.5 — 6 %

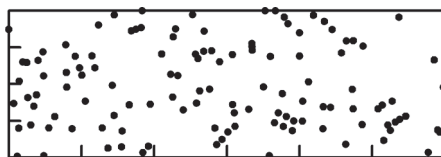

Figure B.6 — 8 %

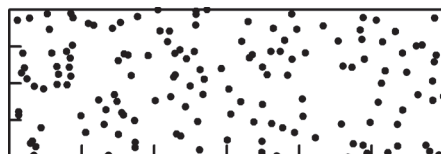

Figure B.7 — 10 %

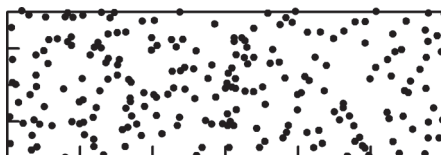

Figure B.8 — 15 %

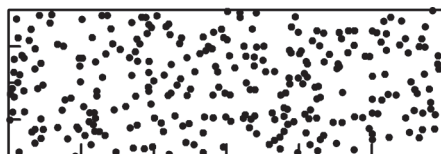

Figure B.9 — 20 %

Annex C (informative)

Sums of acceptable areas

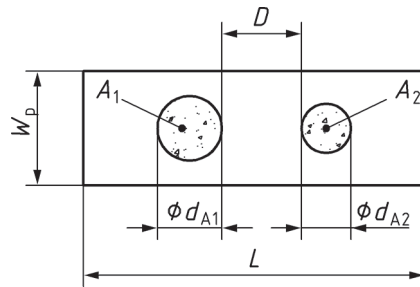

Figure C.1 — Clustered porosity, $D > d_{A2}$

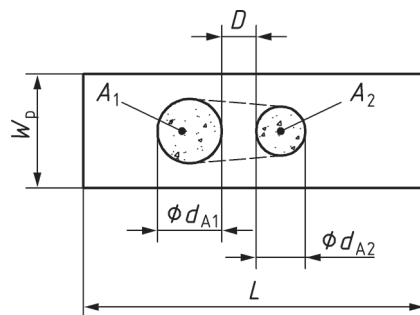

Figure C.2 — Clustered porosity, $D = d_{A2}$

The sum of the different pore areas ($A_1 + A_2 \dots$) related to the evaluation area, $L \times w_p$ (Figure C.1).

If D is less than d_{A1} or d_{A2} , whatever is smaller, an envelope surrounding the porosity area, $A_1 + A_2$, shall be considered as one area of imperfection (Figure C.2).

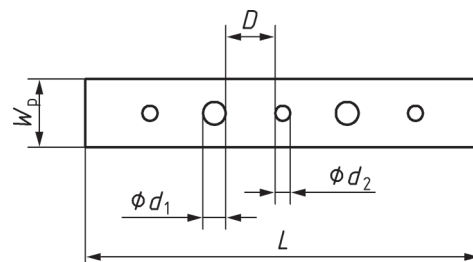

Figure C.3 — Linear porosity, $D > d_2$

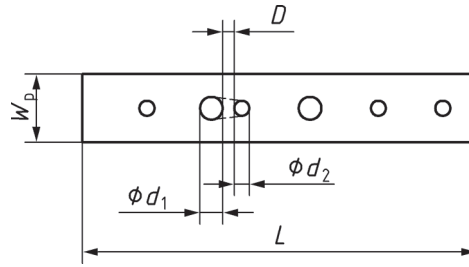

Figure C.4 — Linear porosity, $D = d_2$

The sum of the different pore areas $\left(\frac{d_1^2 \cdot \pi}{4} + \frac{d_2^2 \cdot \pi}{4} + \dots \right)$ related to the evaluation area, $L \times w_p$ (Figure C.3).

If D is smaller than the smaller diameter of one of the neighbouring pores, the full connected area of the two pores is to be taken into the sum of imperfections (Figure C.4).

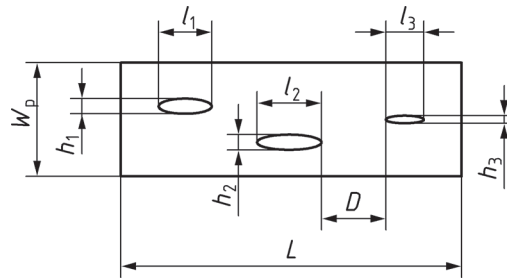

Figure C.5 — Elongated cavities and wormholes, $D > l_3$

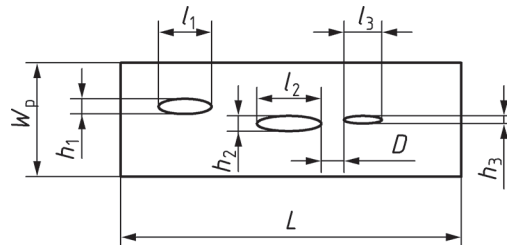

Figure C.6 — Elongated cavities and wormholes, $D = l_3$

The sum of the length of indications, $\sum l$, shall be determined for each testing length, L (Figure C.5).

If D is smaller than the shorter length of one of the neighbouring imperfections, the full connection of the two imperfections is to be taken into the sum of imperfections (Figure C.6).

Bibliography

- [1] ISO 17635, *Non-destructive testing of welds — General rules for metallic materials*
- [2] ISO 17637, *Non-destructive testing of welds — Visual testing of fusion-welded joints*

ISO 10675-2:2017(E)

ICS 25.160.40

Price based on 10 pages

© ISO 2017 – All rights reserved